



JTgK-500i

High Speed Engraving and Milling CNC Machine

Product descriptions and features

Features

- Optimized design, more stable and reliable
- Excellent machining performance
- Concise all-in-one structure

For Material

Nonmetal, copper, aluminum alloy, carbon steel, alloy steel

Applied Range

Electrode, mold, hardware, artware, machine parts, equipment manufacture, etc



KEJIE website



KEJIE wechat

Parameters

Item	Parameter
Working area X/Y/Z	500/400/230mm
Work table size	500x400mm
Max load of table	150kg
Spindle power Max spindle speed	4.0kw/30000rpm or 3.7kw/24000rpm
Rapid traverse rate	12m/min
Cutting feed rate	10m/min
Positioning accuracy	0.008mm
Repeatability	0.005mm
Weight	2700kg
Machine dimension	1800x1600x2200mm
Power supply	3-PH AC380V ±5% 50Hz

Standard Accessories

- High speed CNC controller
- High speed spindle
- AC servo motor
- Precision ball screw and guide rail
- Tool setting sensor
- Hand Wheel
- Spindle cooling system

Optional Accessories

- Automatic tool changer
- Voltage stabilizer
- Oil mist collector
- Probe

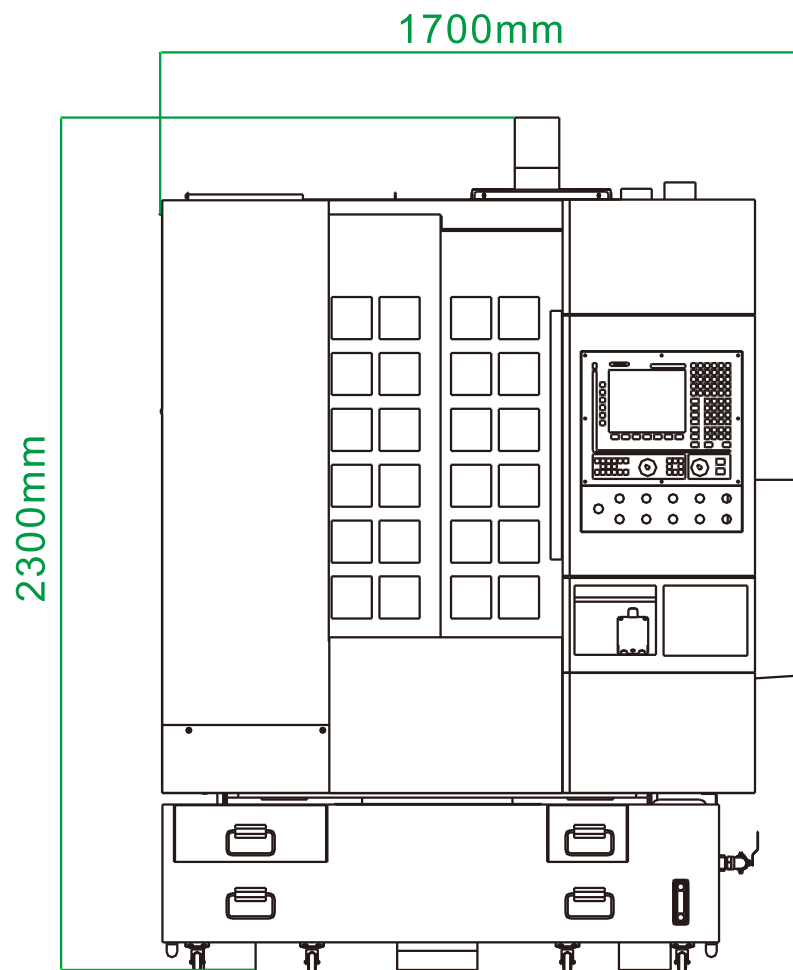

Front

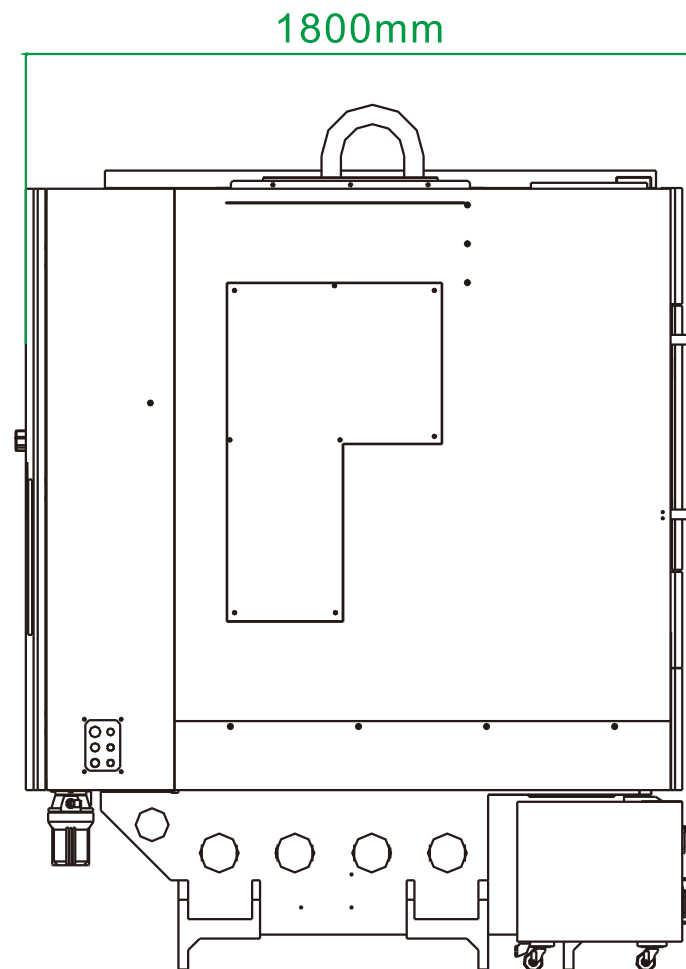

Left